



Room Specifications

	Coleman Suite	Coleman One	Coleman Two	Coleman Three	Boyne Suite	Boyne One	Boyne Two	Boyne Three	Boyne + Coleman	Board Room	John Burdon
Dinner Dance (rounds)	320	90	80	70	100	40	—	—	420	—	120
Dinner Dance (trestles)	360	100	100	80	120	—	—	—	490	—	120
Presentation Dinner (rounds)	360	100	100	90	130	60	—	—	490	—	90
Presentation Dinner (trestle)	400	100	100	80	120	60	—	—	530	—	110
Theatre-style	600	120	120	100	120	50	30	40	—	—	60
School Room	280	90	90	80	—	30	20	30	—	—	40
Board Room	—	50	50	50	—	28	25	30	—	20	30
U-shape	—	50	50	50	—	24	—	30	—	—	30
Disco	800	200	150	150	150	60	—	—	950	—	350
Area (sq m)	435	155	145	138	176	80	48	48	611	43	—
Room Height min (m) max (m)	4.85 5.55	4.85 5.55	4.85 5.55	4.50 5.55	2.95	2.90	2.95	2.90	—	2.90	—
Length (m)	26.20	17.88	16.58	15.83	28.30	10.18	10.50	10.00	—	5.05	—
Width (m)	16.58	8.65	8.70	8.85	—	7.81	4.61	4.81	—	5.05	—
Door Height (m)	2.65	2.25	2.25	2.25	1.95	1.95	1.95	1.95	1.95	—	2.00
Door Width (m)	5.96	1.55	1.55	1.55	1.45	1.45	1.45	1.45	1.45	—	0.94
Blackout	yes	yes	yes	yes	yes	yes	yes	yes	yes	yes	—
Sound System	yes	yes	yes	yes	no	no	no	no	50%	no	no
3-phase	yes	yes	yes	yes	no	no	no	no	50%	no	yes
13A Sockets	58	12	22	24	34	16	10	8	92	8	2
Dimmers	yes	yes	yes	yes	yes	yes	yes	yes	yes	yes	yes
Disabled Access	yes	yes	yes	yes	yes	yes	yes	yes	yes	no	yes
Telephone Sockets	5	1	2	2	3	1	1	1	8	1	2
ISDN	yes	yes	yes	yes	no	no	no	no	50%	no	no
Air Conditioning	yes	yes	yes	yes	no	no	no	no	50%	no	yes
Bar Facilities	yes	yes	no	yes	no	no	no	no	50%	no	yes
Vehicle Access Door	yes	no	no	yes	no	no	no	no	50%	no	no



Conference and Banqueting Capacities

Maximum numbers and room sizes

	Coleman Suite			Boyne Suite			Boyne + Coleman	Board Room	John Burdon
	one section	two sections	three sections	one section	two sections	three sections			
Dinner Dance (rounds)	90	220	320	50	76	100	420	—	140
Dinner Dance (trestles)	170	250	440	50	76	130	570	—	160
Presentation Dinner (rounds)	110	240	360	58	84	130	490	—	110
Presentation Dinner (trestles)	150	300	500	58	84	160	660	—	90
Theatre-style	180	230	450	50	80	180	—	—	60
School Room	80	180	280	30	50	—	—	20	30
Board Room	60	—	—	40	—	—	—	20	30
Disco	150	350	800	60	100	150	950	—	350
Area (sq m)	155	300	435	80	128	176	611	43	—
Room Height min (m) max (m)	4.85 5.55	4.85 5.55	4.85 5.55	2.95	2.95	2.95	—	2.90	—
Door Height (m)	2.25	2.25	2.25	1.95	1.95	1.95	—	2.00	—
Door Width (m)	1.55	1.55	1.55	1.45	1.45	1.45	—	0.94	—

Audio Visual Equipment and Facilities

- Video Conferencing using ISDN 30
- Back Projection, Lecterns, Roving and Fixed Microphones
- Television Monitors, VHS Video
- 35mm Carousel Projector
- PA System
- Local or Background Music
- 3-phase Power
- Portable Staging and Dance Floor
- 6 x Chandeliers
- Projection Screens
- Fluorescent and Spot Lighting
- In-room Dining facility
- 9-hour Lumbar Chairs
- Large access doors for vehicles
- Fax, e-mail, Internet, Photocopying, Computer Publishing and Secretarial Assistance are all available within the Hotel. Charges for uses are made accordingly.
- We have WI-FI installed, so the internet is accessible throughout the hotel. Rates on application.
- We have no objection to you bringing your own equipment



Function Suites

COLEMAN SUITE

Opened in July 2001 the Coleman Suite consists of three rooms divided by portable acoustic walls, two entrances, full air-conditioning and six chandeliers with glittering Austrian Strauss crystal. The possibilities are endless.

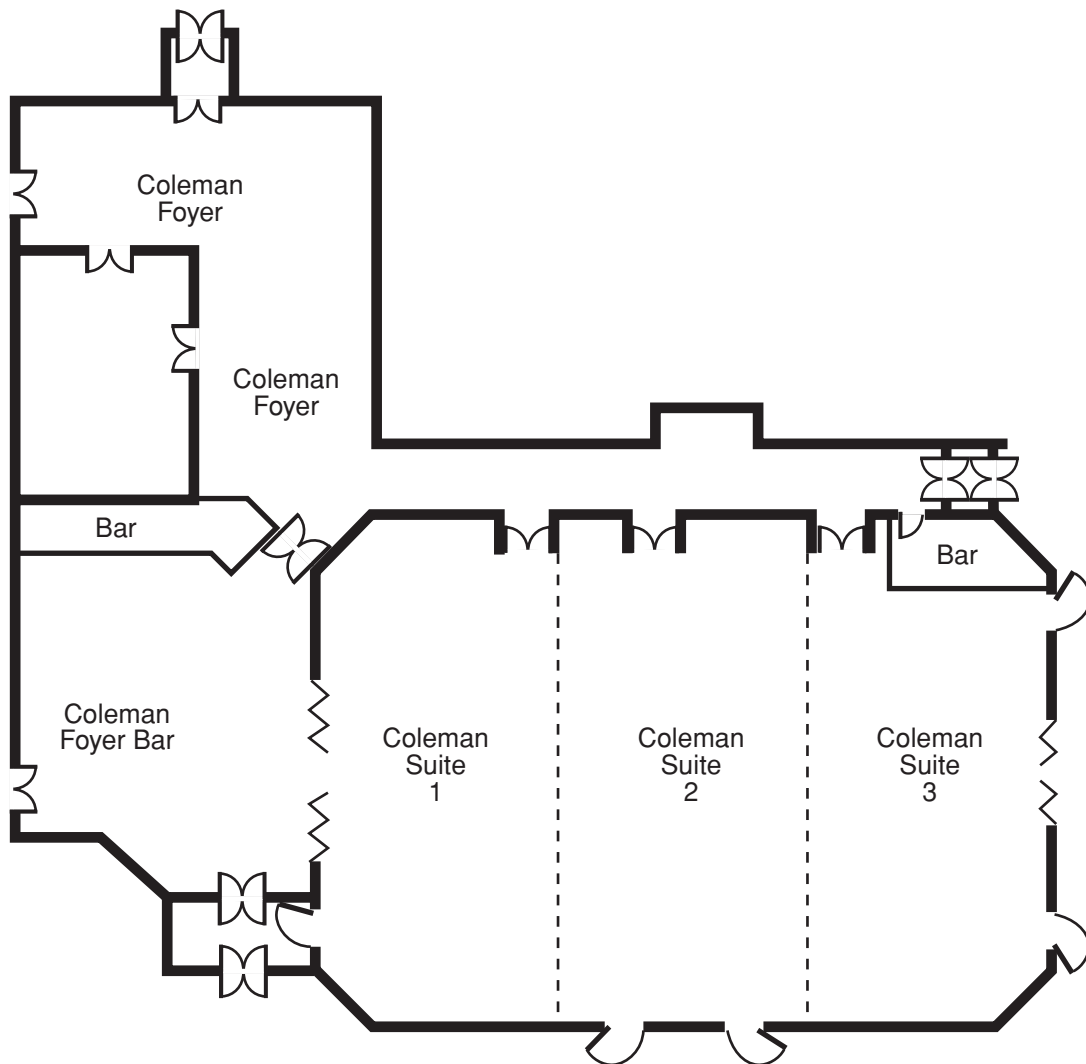

HARDWICK HALL
HOTEL



Function Suites

BOYNE SUITE

The traditional venue at Hardwick Hall.
The Hardwick Bar and Lounge serves this Suite.

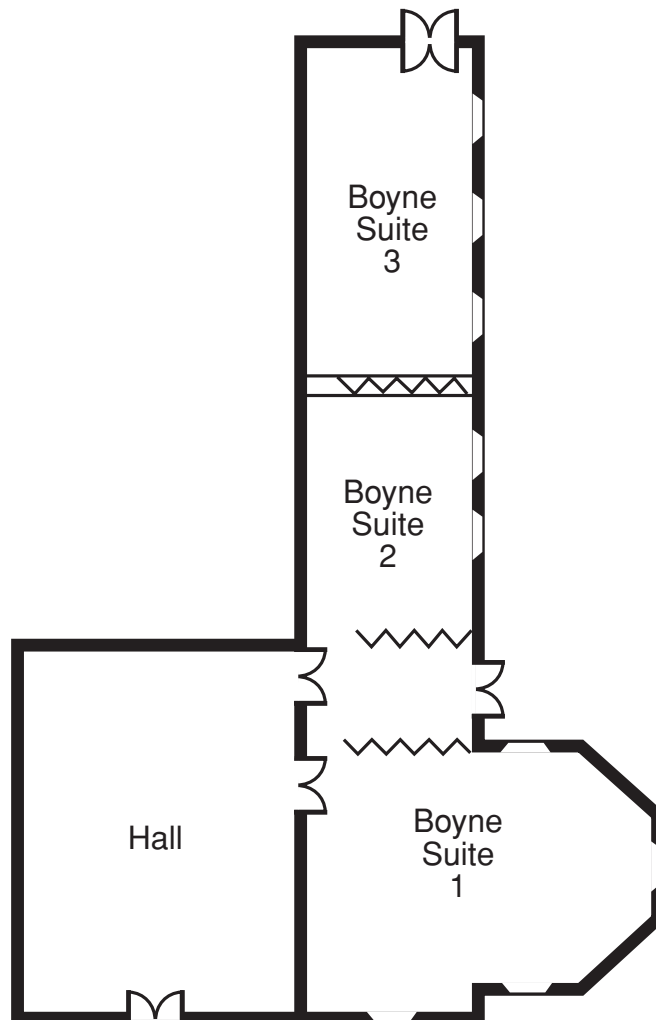

HARDWICK HALL
HOTEL