



A town for all seasons  
**Matlock**  
 A Great Place to Stop and Shop!

## Welcome to Matlock



Whether this is your first trip to Matlock or you are frequent visitor, there is plenty to see and do in this friendly and historic town.

Take time to explore Matlock. Take a stroll in our award winning Hall Leys Park, a place for leisure since Victorian times. Enjoy shopping and sample our cafes and restaurants.

There are various trails and walks which take in the picturesque River Derwent and show you the hidden heritage of Matlock – look

out for the information panels and maps throughout the town which give you more detail of the rich history all around us.



There are different shopping areas around the town, all within walking distance and each overlooked by some of the most stunning scenery you could wish for.

Please enjoy using the map inside this leaflet to explore and discover how much Matlock has to offer.



www.matlock.gov.uk



Matlock - A Great Place to Stop and Shop!



The Derwent Valley Line is operated by East Midlands Trains as part of their train services across the East Midlands. The Journey time to Matlock from Derby is 32 minutes. Matlock benefits from an hourly train service from an Derby and Nottingham. Relax and enjoy the picturesque landscape as the train brings you into Matlock through the picturesque Derwent Valley Mills World Heritage Site.

For Rail Times and Fare Enquiries call National Rail 48 49 50, see their website [www.nationalrail.co.uk](http://www.nationalrail.co.uk) or see the timetable posters at Matlock station.



Before you stepped on the tram, which would have taken you up Bank Road to the hydros, you may have taken a stroll down Dale Road for some retail therapy.

Many of the impressive buildings you see today date back to Victorian times.

Dale Road became a popular shopping area with visitors who came to Matlock for

the many different water treatments.

Hotels, pubs, a market hall, jewellers and clothes shops lined either side of the road.

Over the last 150 years Matlock has grown and developed to accommodate visitors and locals looking for all the services and choice we came to expect in our local town centre. The shopping areas have extended to take in Causeway Lane, Crown Square, Firs Parade and Matlock Green.

A 'shop local' campaign is breathing new life into Matlock and as part of that we invite you to sample and support the produce and products on offer at an enviable range of independent shops and local services.



There is so much to explore in and around Matlock using public transport. Hop on the bus or train and enjoy the scenery at your leisure. Matlock has developed hugely from its transport links. River, canal, tram, road and rail have all had a major influence. From Matlock, the scenic Peak District and its picturesque villages are a virtual ride away. Matlock Bath provides a great family day out with its many attractions or discover the Derwent Valley Mills World Heritage Site. All Tickets are valid for one-day from first bus to last bus and on trains after 0900 (or at any time if a Saturday, Sunday or Bank Holiday Monday). Regular bus services operate making Matlock easily accessible by bus from surrounding towns

## Matlock - A Well Connected Town

## Matlock - A Place to Stop

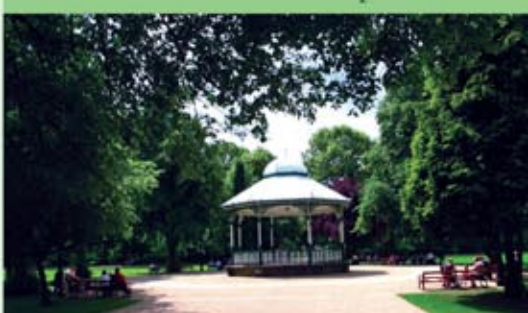

Throughout the year, events in and around Matlock provide something to suit every taste;

- Farmers' markets are held in the Imperial Rooms on the 3rd Saturday of every month. Local suppliers and producers supply a wide range of organic meat, produce, bread, cakes and crafts.
- Matlock Live! is held in July and is a celebration of performing and visual arts in and around Matlock.
- On Sunday afternoons from June until the end of August Brass Band Concerts provide entertainment in Hall Leys Park.
- Victorian Matlock Christmas Weekend is always held on the first weekend of December and is a celebrated

event offering family entertainment, a magical parade and a spectacular fireworks display. Here you can buy local produce and crafts and enjoy a feast of family entertainment.

■ The Boxing Day raft race is another local tradition not to be missed with entrants travelling from far and wide to fill the River Derwent with their fantastic and imaginative creations.

For more details on the above and all events happening in Matlock, please visit the Tourist Information Centre (see map) or telephone: 01629 583388

We hope you enjoy your visit to Matlock whatever time of year.

# Shopping in Matlock

## Shop Directory

- Car Sales & Services**
  - Abworth's Motor Sales
  - PG Automotive
  - Matlock Green Garage
  - Matlock Road
  - Sainsbury's
  - A & M's Garage
  - Mr Tyne
  - Total Garage
  - Mr D I Smith
  - Sebesta Tyne
  - Farmers
  - Matlock MOT
  - Bristol Street Motors
- Computer, Phones & Electrical**
  - The Real Computer Shop
  - Jag
  - Computer Supplies/Mad for Ink
  - Farmers Electrical
- Fashion & Accessories**
  - British Red Cross Shop
  - Help the Aged
  - Save the Children
  - Bridal Studio
  - Geoff Stevens Ladies & Menwear
  - Silvianox
  - Broughton Shoes
  - Braddens
  - W Evans & Sons
  - The Bee Tree
  - Wards Shoe Shop
  - Zhivago
  - Sue Ryder
  - R H Williams
  - Hair Care
  - Peak Podiatric & Sports Injury Clinic
  - Barb's UK
- Home & Garden, Design, DIY**
  - Twigg
  - Curtain Call
  - Matlock Antiques & Collectors Centre
  - Banforbs Auctions
  - J Scott
  - Inner Peace
  - World Span
  - Indigo Furniture
  - Pre-Insulation
  - Matlock Lammy
  - Matlock Glass
  - Fleur
  - Wilkinson
  - Haylin Stanley
  - Matlock Kitchen & Bathroom Centre
  - Derwent Carpets and Curtains
  - Seving Center
  - The Leather Shop
  - Elliott Carpets
  - Matlock Town Council
  - Lime Grove Medical Centre
  - Job Centre
  - Records Office
  - High Peak Cleaners
  - Crescent Upholstery
  - ADI Trading
  - Murlough Antiques
  - Kitchen Lifestyle
  - Designate
- Financial, Legal, Property Services**
  - Nationwide
  - Derwent Financial Services
  - Sally Bodham
  - Citizens Advice Bureau
  - Henry, Lovelady & Keighley
  - Colman Brokerlaw
  - Loyds TSB
  - Fisher Taylor
  - Britannia Building Society
  - Halfax
  - Derbyshire Building Society
  - Chubb & Co.
  - HSBC (Miffland Bank)
  - Not West
  - Water & Co
  - Sargall Mann & Co
  - Beccwoods
  - Mills & Black
  - Elliott Mathers
  - Chambers, Cope & Partners
  - Peak Insurance
  - RBS

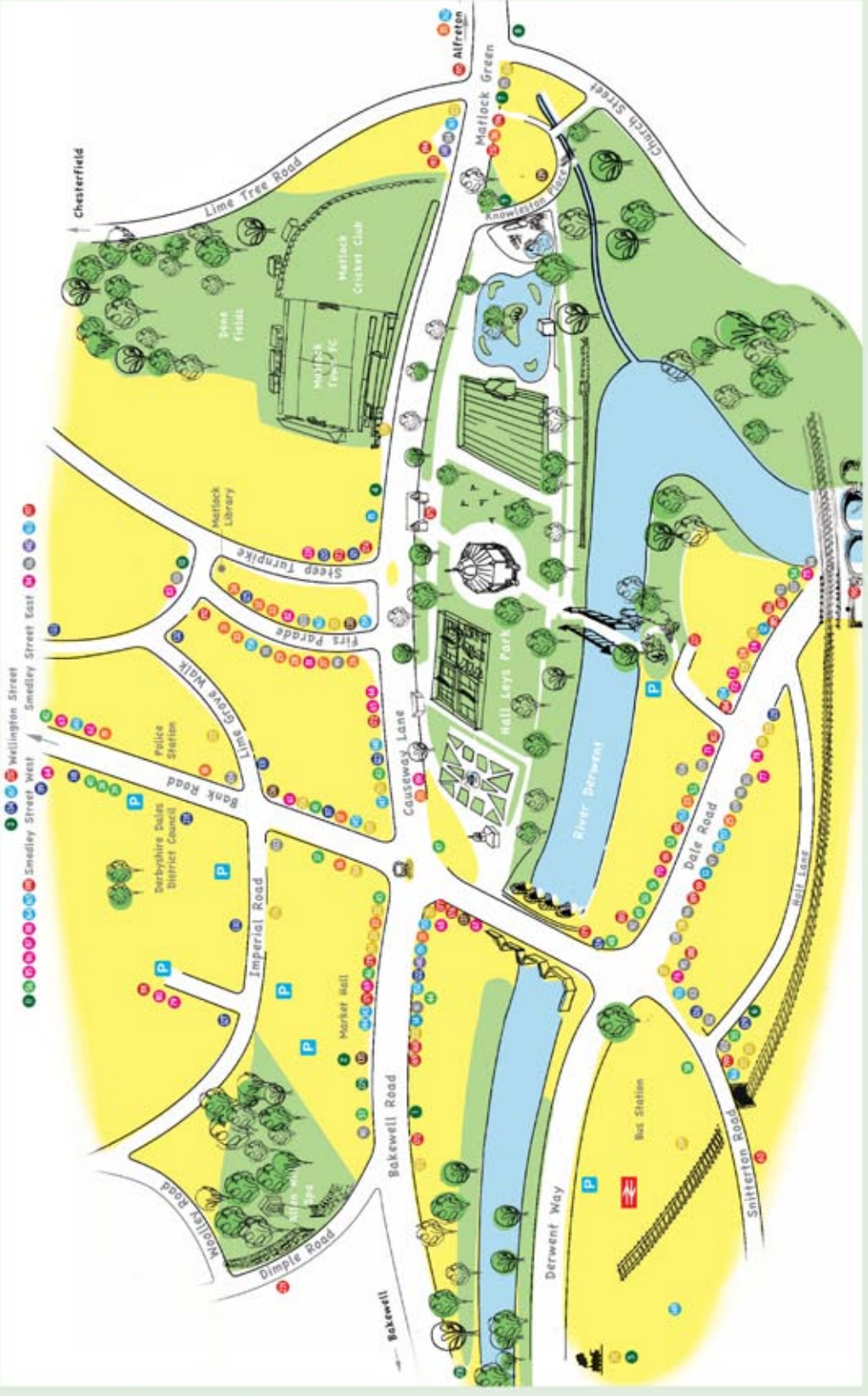

- Local Authority, Education, Health**
  - David Bray Optician
  - Springmount Dental Practice
  - Derbyshire County Council (DCC)
  - NHS
  - Derbyshire County Council
  - Adult Education
  - Conesdon
  - Lancaster & Thorpe
  - Dale Opticians
  - Matlock Training Club
  - Probation Office
  - The Surgery
  - Matlock Dental Practice
  - Holt House Dental Care
  - Matlock Town Council
  - Job Centre
  - Lime Grove Medical Centre
  - Derbyshire County Council
  - Records Office
  - Derbyshire County Council
  - Trading Standards
  - Derbyshire Dales District Council
- Local Services**
  - Matlock Copy Centre
  - Matlock Post Office
  - Tourist Information Centre
  - Matlock Mercury
  - Thomas Groceries
- Newsagents, Gifts and Cards**
  - Matlock China & Glass
  - Ginger Cards
  - Matlock Green News
  - Geoff Armit
  - Bridge News
  - Peak Delights
  - Shaves
- Places to Buy Food and Drink**
  - Somerford
  - Smart's Fruit & Veg
  - Hambridge
  - Cobs & Cakes
  - Mrs Tugby Winkles
  - Birds the Confectioners
- Places to Relax with Food & Drink**
  - The Railway
  - Pauls Cafe Bar
- Local Services**
  - Matlock Antiques & Collectors Centre
  - Banforbs Auctions
  - J Scott
  - Inner Peace
  - World Span
  - Indigo Furniture
  - Pre-Insulation
  - Matlock Lammy
  - Matlock Glass
  - Fleur
  - Wilkinson
  - Haylin Stanley
  - Matlock Kitchen & Bathroom Centre
  - Derwent Carpets and Curtains
  - Seving Center
  - The Leather Shop
  - Elliott Carpets
  - Matlock Town Council
  - Lime Grove Medical Centre
  - Job Centre
  - Records Office
  - High Peak Cleaners
  - Crescent Upholstery
  - ADI Trading
  - Murlough Antiques
  - Kitchen Lifestyle
  - Designate

- Local Services**
  - Matlock Copy Centre
  - Matlock Post Office
  - Tourist Information Centre
  - Matlock Mercury
  - Thomas Groceries
- Newsagents, Gifts and Cards**
  - Matlock China & Glass
  - Ginger Cards
  - Matlock Green News
  - Geoff Armit
  - Bridge News
  - Peak Delights
  - Shaves
- Places to Buy Food and Drink**
  - Somerford
  - Smart's Fruit & Veg
  - Hambridge
  - Cobs & Cakes
  - Mrs Tugby Winkles
  - Birds the Confectioners
- Places to Relax with Food & Drink**
  - The Railway
  - Pauls Cafe Bar

- Places to Relax with Food & Drink**
  - The Railway
  - Pauls Cafe Bar
- Places to Buy Food and Drink**
  - Somerford
  - Smart's Fruit & Veg
  - Hambridge
  - Cobs & Cakes
  - Mrs Tugby Winkles
  - Birds the Confectioners
- Local Services**
  - Matlock Copy Centre
  - Matlock Post Office
  - Tourist Information Centre
  - Matlock Mercury
  - Thomas Groceries
- Newsagents, Gifts and Cards**
  - Matlock China & Glass
  - Ginger Cards
  - Matlock Green News
  - Geoff Armit
  - Bridge News
  - Peak Delights
  - Shaves

- Sports, Hobbies and Leisure**
  - The Horse Shoe
  - Towney's Coffee Shop
  - Matlock Fish Bar
  - The Gate
  - Cafe Centre
  - Cafe in the Park
  - The Green Way Cafe
  - Duke of Wellington
  - Stones Restaurant
  - Riverside Cafe
  - Regent House
  - Thailand No 1
  - Monk
  - Fortune Chinese Food
  - Harvey's Bar
  - Fortune Chinese Food
  - Fanz
  - The Black Cat Cafe
  - Rembevous
  - The Boat House
  - Edgefold Club
  - Lennon Grass
  - Real Lion
  - Country Cottage Restaurant

Matlock is proud to be a Fairtrade Town. Use the Fairtrade symbol to shop for and enjoy Fairtrade products around the town.

www.matlock.gov.uk

Matlock is proud to be a Fairtrade Town. Use the Fairtrade symbol to shop for and enjoy Fairtrade products around the town.

www.matlock.gov.uk

Matlock is proud to be a Fairtrade Town. Use the Fairtrade symbol to shop for and enjoy Fairtrade products around the town.

www.matlock.gov.uk